

**ANTIVIBRANTI
CAMPANA COMPONENTI**

**MODULAR
ANTI-VIBRATION BELL MOUNTS**



PER SCEGLIERE IL SUPPORTO ANTIVIBRANTE CORRETTO BISOGNA CONOSCERE:

1. **PESO STATICO** della macchina e **NUMERO DEI PUNTI DI APPOGGIO** con rispettivo carico gravante.
2. **FREQUENZA ECCITANTE** determinata dal corpo rotante con r.p.m. più bassa.
3. **LUOGO D'INSTALLAZIONE:** se la macchina viene installata in una zona sismica, in copertura, se è soggetta alle forze del vento o in una zona con elevata presenza di nebbie saline o altri agenti aggressivi.
4. **TEMPERATURA D'IMPIEGO:** bisogna tenere in considerazione le temperature alle quali saranno soggetti i supporti antivibranti.

L'INSTALLAZIONE È CORRETTA QUANDO TUTTI I SUPPORTI INSTALLATI PRESENTANO LA STESSA FRECCIA ELASTICA.

Se le basi di appoggio dei diversi supporti antivibranti non sono tra loro a livello, è necessario compensare tale mancanza utilizzando appositi registri (MARTINETTI).

TO CHOOSE THE CORRECT ANTI-VIBRATION MOUNT, YOU MUST KNOW:

1. The **STATIC WEIGHT** of the machine and the **NUMBER OF SUPPORT POINTS** with their respective loads;
2. The **EXCITATION FREQUENCY** determined by the rotating body at the lowest r.p.m..
3. **INSTALLATION SITE:** if the machine is installed in a seismic area, on the roof, if it is subject to wind forces or in an area with high presence of saline mists or other aggressive agents.
4. **WORKING TEMPERATURE:** the temperatures to which the anti-vibration mounts will be subject must be taken into consideration.

THE INSTALLATION IS CORRECT WHEN ALL THE INSTALLED MOUNTS HAVE THE SAME ELASTIC DEFLECTION.

If the support bases of the different anti-vibration mounts are not among them at level, it is necessary to compensate for this lack using special registers (JACKS).

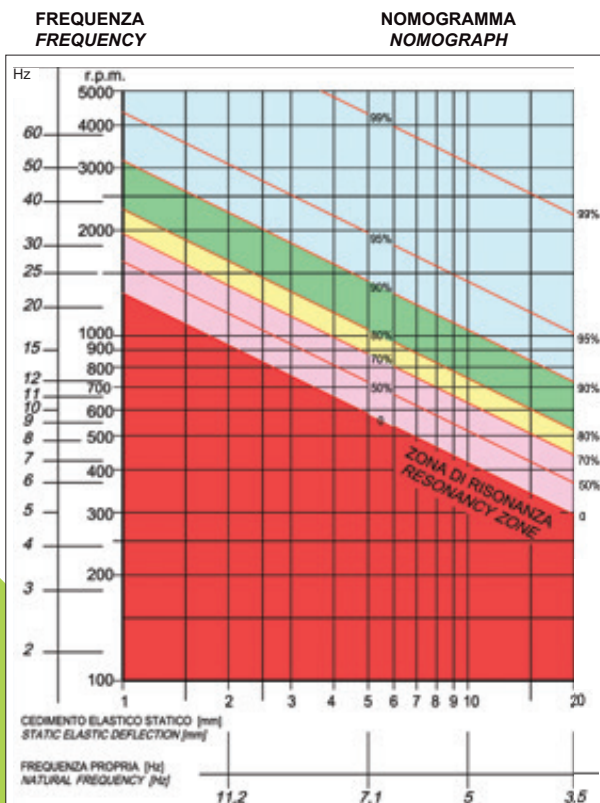

Il diagramma degli isolamenti, riassume graficamente, le relazioni intercorrenti tra la freccia elastica espressa in mm, il regime vibrante in r.p.m. o i cicli/mm e il grado di isolamento espresso in %.

The insulation diagram shows graphically the ratios between the elastic deflections in mm, the vibration speed in r.p.m. or cycles/mm and the degree of insulation as a %.

	ottima very good
	buona good
	discreta fair
	sufficiente sufficient
	zona di risonanza resonant zone

ESEMPIO DI SCELTA DI UN SUPPORTO ANTIVIBRANTE:

Si supponga di dover isolare un gruppo frigorifero di 6.234 kg con una frequenza pari a 1800 r.p.m. (30 Hz).

L'unità ha 6 punti di appoggio, su ogni punto d'appoggio gravano 1039 kg (il carico è uniformemente distribuito).

Per ottenere un isolamento del 90% ca. è necessaria una deflessione (freccia) di ca. 4 mm.

Nella scelta del supporto antivibrante controllare che il carico massimo consigliato sia superiore al carico applicato.

Per la corretta installazione consultare l'apposita guida tecnica.

Soleco engineering s.r.l. non si assume responsabilità nei casi dove si evidenzia l'errata installazione del supporto.

EXAMPLE OF CHOICE OF ANTI-VIBRATION MOUNT:

Suppose you need to isolate a 6234 kg refrigeration unit with one frequency equal to 1800 r.p.m. (30 Hz).

The unit has six resting points with 1.039 kg resting on each point (the load is evenly distributed).

To achieve about 90% insulation, a deflection of about 4 mm. is necessary.

When choosing the anti-vibration mount, check that the maximum recommended load is higher than the load applied.

Please consult the technical guide for correct installation.

Soleco Engineering S.r.l. declines all responsibility in cases where the incorrect installation of the support is detected.

**SERIE CAMPANA
BELL SERIES**



MODELLI

Disponibile in 3 grandezze per supportare carichi elevati e dotati di fori asolati per adattarsi alle più comuni misure di fissaggio.

Ogni modello può essere fornito in 3 diverse durezza che vengono identificate dal colore del cuscinetto posto sulla base superiore del supporto.

Il cuscinetto è dotato di rilievi deformabili antiscivolo che consentono all'antivibrante caricato di stazionare per attrito e nel contempo di ridurre la trasmissione di rumori.

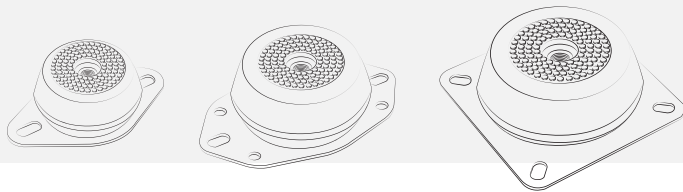

MODELS

Available in 3 sizes to support high loads and equipped with slotted holes to adapt to the most common fixing measures.

Each model can be supplied in 3 different hardnesses which are identified by the color of the bearing placed on the upper base of the support.

The pad has slip-proof, flexible embossing which allow the charged anti-vibration mount to stand by friction and at the same time reduce the transmission of noise.



CORPO ELASTICO

GOMMA NATURALE indicata per applicazioni in ambienti con temperature comprese fra -25°C e $+90^{\circ}\text{C}$ (disponibile in mescole speciali NBR, HNBR e EPDM).

ELASTOMERO TERMOPLASTICO ideale per applicazioni in ambienti con temperature di impiego da -45°C a $+110^{\circ}\text{C}$ per i 45 e 70 ShA e da -55°C a $+135^{\circ}\text{C}$ per il 60 ShA.

La mescola, in termoplastica riciclabile, presenta una elevata resistenza all'invecchiamento, alle sostanze inquinanti, agli idrocarburi, nebbie saline, raggi UV e detersivi.

ELASTIC BODY

NATURAL RUBBER suitable for applications in environments with temperatures between -25°C and $+90^{\circ}\text{C}$ (available in special NBR, HNBR and EPDM compounds).

THERMOPLASTIC ELASTOMER ideal for applications with temperatures ranging from -45°C to $+110^{\circ}\text{C}$ for the 45 and 70 ShA version and from -55°C to $+135^{\circ}\text{C}$ for the 60 ShA version.

The compound, in recyclable thermoplastic, has a high resistance to ageing, pollutants, hydrocarbons, salt mist, UV rays and detergents.



**CERTIFICATI E
BREVETTATI
CERTIFIED AND
PATENTED**

BUSSOLA ANTISTRAPPO DI SERIE

NESSUN RISCHIO DI RIBALTAMENTO

I supporti a **CAMPANA Soleco** sono stati testati presso il Politecnico di Milano e hanno soddisfatto in modo eccellente le aspettative assicurando il raggiungimento dei più alti standard qualitativi.

I supporti a **CAMPANA Soleco** sono protetti da **BREVETTO** in **ITALIA** e all'**ESTERO**.

STANDARD ANTI-TEAR PROTECTION

NO RISK OF OVERTURN

Soleco BELL mounts have been tested at the Politecnico di Milano and have successfully met all the requirements, guaranteeing the highest standards of quality.

Soleco BELL mounts are protected by **PATENT** in **ITALY** and **ABROAD**.



STRUTTURA METALLICA

ACCIAIO ZINCATO UNI EN 10111 DD13 con superficie zincata **UNI ISO 2081 Fe/Zn 15c1A** bianca.

ACCIAIO INOX AISI 316 adatto per il settore **OFFSHORE**, alimentare e sanitario.

Inoltre, utilizzato in combinazione con l'elastomero termoplastico, è la soluzione ideale per applicazioni in ambienti con **TEMPERATURE ESTREME**.

METAL STRUCTURE

GALVANIZED STEEL UNI EN 10111 DD13 steel with **UNI ISO 2081Fe/Zn 15c1A** white galvanized coating.

AISI 316 STAINLESS STEEL suitable for **OFFSHORE**, food and health sectors.

In addition, used in combination with thermoplastic elastomer, it is the ideal solution for applications in environments with **EXTREME TEMPERATURES**.



MODELLI
MODELS

6231

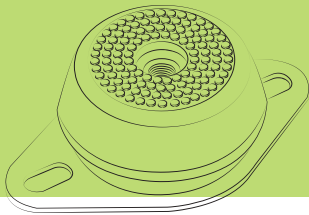

9245

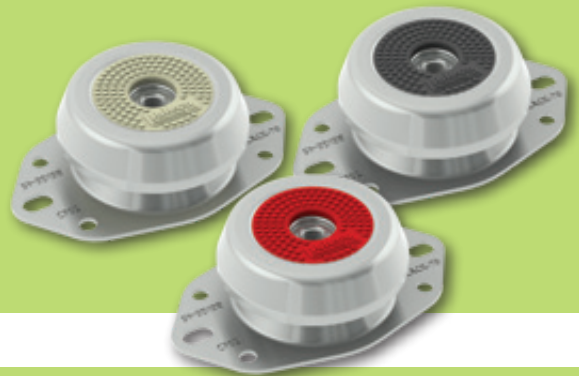
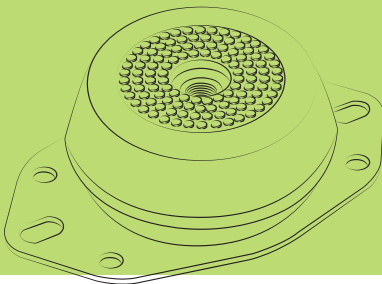

15050

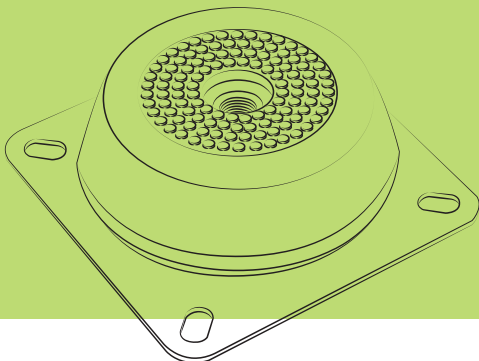

**DIMENSIONALI
DIMENSIONS**

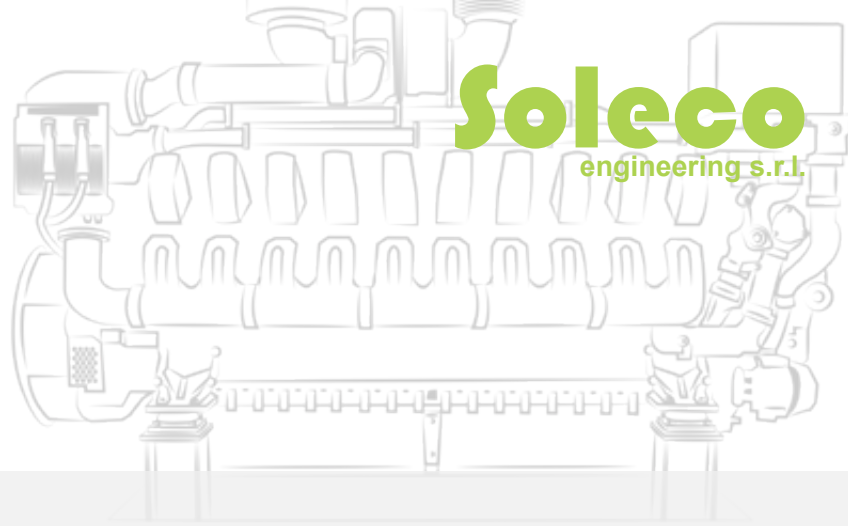

6231

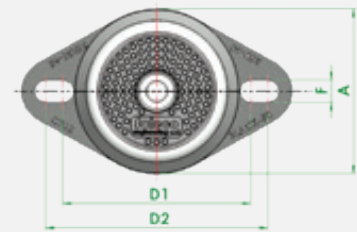
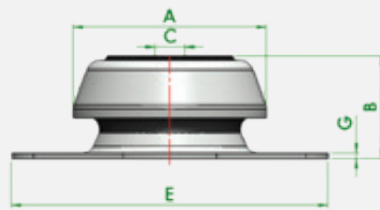

9245

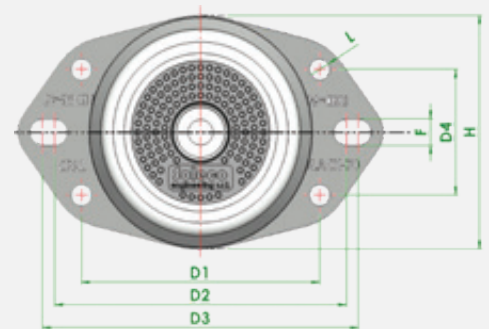
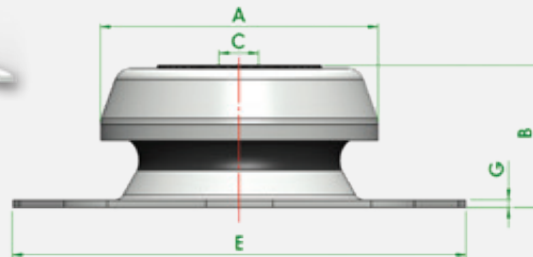

15050

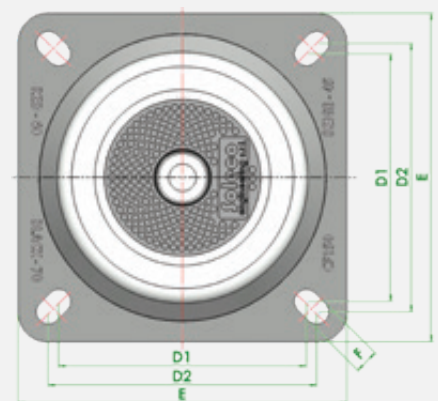
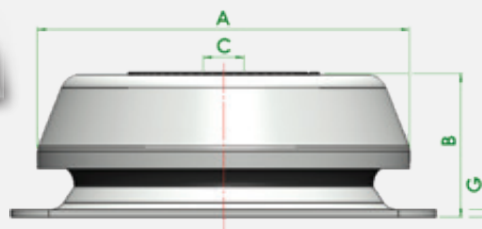

DIMENSIONS	C	A mm	B mm	D1 mm	D2 mm	D3 mm	D4 mm	E mm	F mm	G mm	H mm	L mm	WEIGHT kg
6231	M10 M12	67	34	76.5	90.5			110	9	2			0.25
9245	M12 M16	92	44	98	120	130	50	150	10.5	2.5	93	8.5	0.60
15050	M16 M20	147	56		138			168	12.5	3			1.84



6231

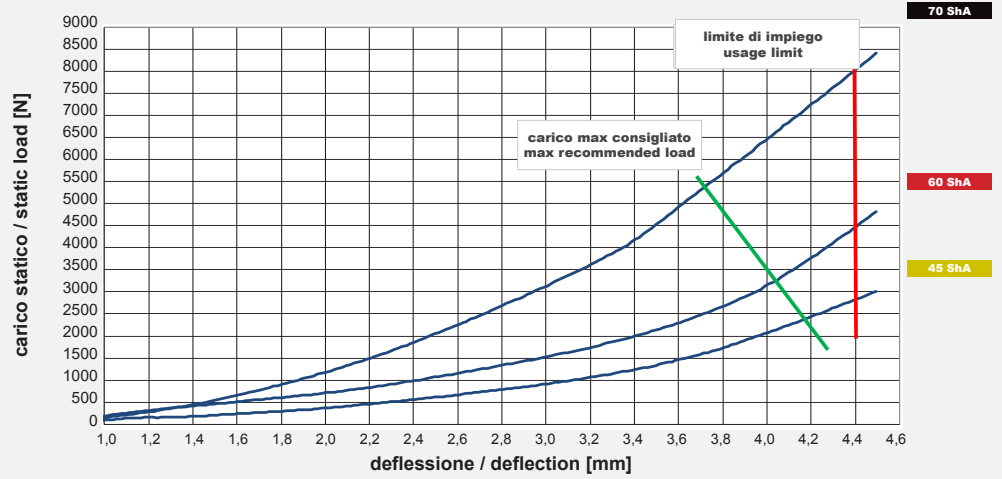
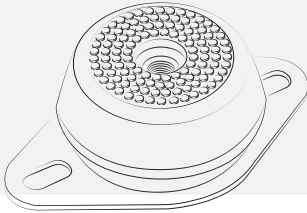

9245

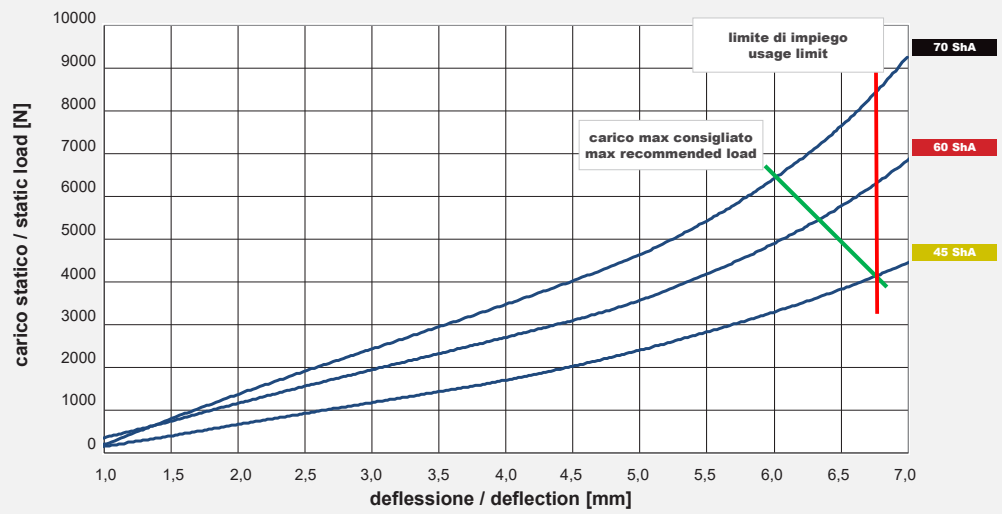
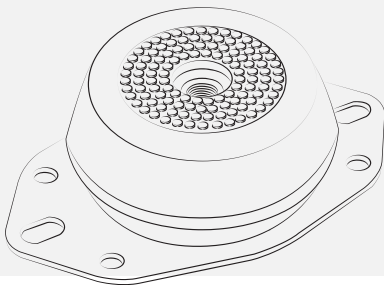

15050

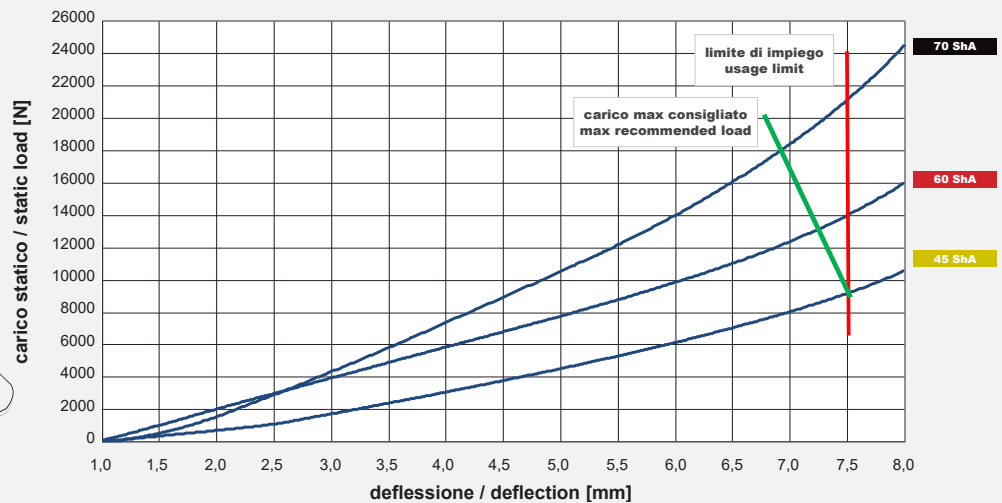
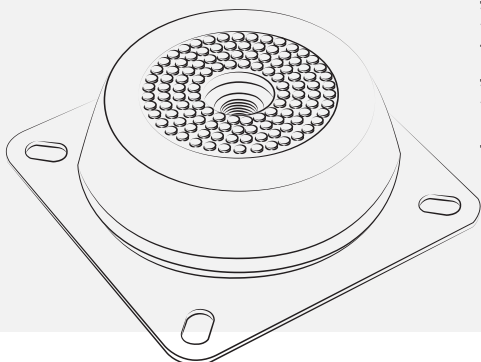

**ELASTOMERO
TERMOPLASTICO
THERMOPLASTIC
ELASTOMER**

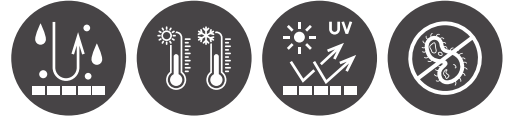

6231

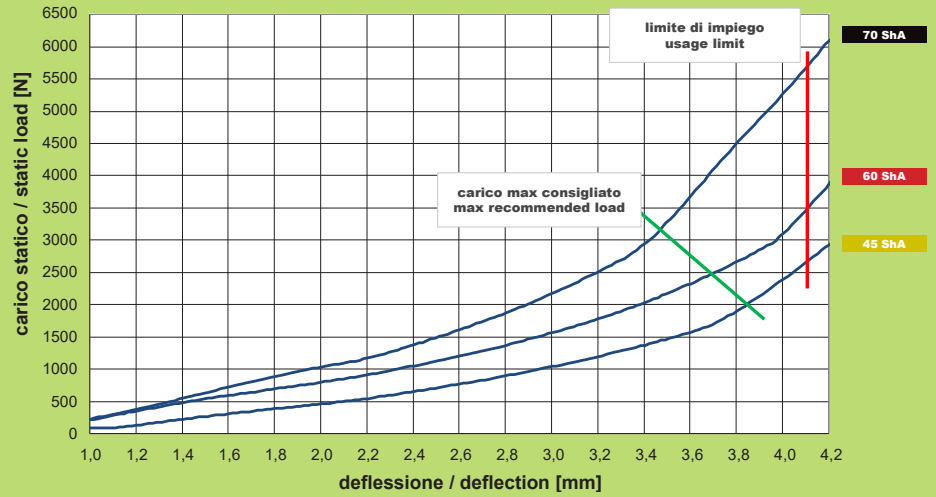
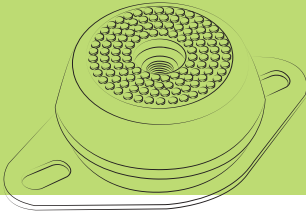

9245

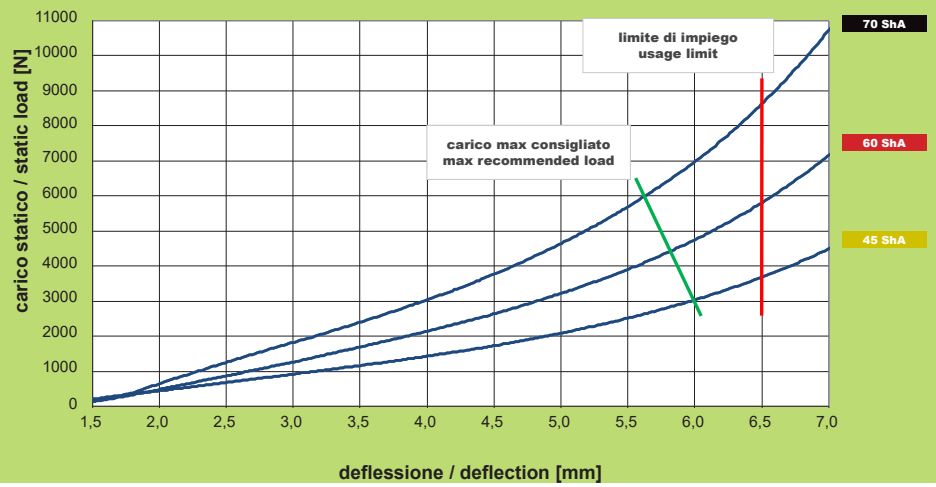
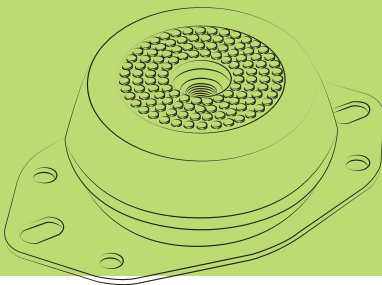

15050

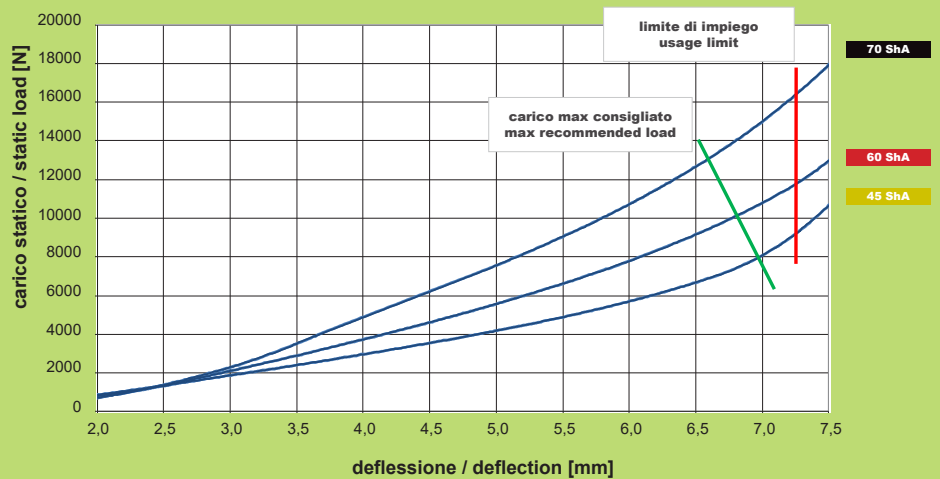
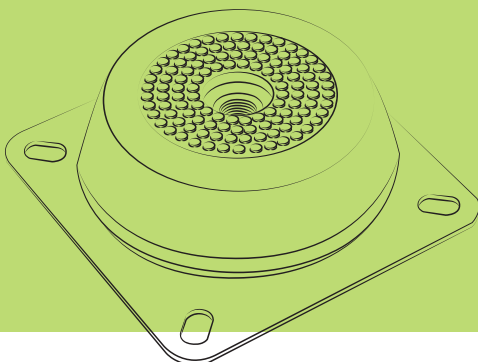

CODICI PRODOTTO
PRODUCT CODES

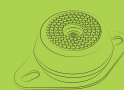

6231

CODICE / CODE	STRUTTURA METALLICA / METAL STRUCTURE	CORPO ELASTICO / ELASTIC BODY
CFNRNR6231	ACCIAIO ZINCATO / GALVANIZED STEEL	GOMMA NATURALE / NATURAL RUBBER
CFNRNRX6231	ACCIAIO INOX AISI 316 / AISI 136 STAINLESS STEEL	GOMMA NATURALE / NATURAL RUBBER
CFNE6231	ACCIAIO ZINCATO / GALVANIZED STEEL	ELASTOMERO TERMOPLASTICO / THERMOPLASTIC ELASTOMER
CFNEX6231	ACCIAIO INOX AISI 316 / AISI 136 STAINLESS STEEL	ELASTOMERO TERMOPLASTICO / THERMOPLASTIC ELASTOMER

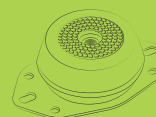

9245

CODICE / CODE	STRUTTURA METALLICA / METAL STRUCTURE	CORPO ELASTICO / ELASTIC BODY
CFNRNR9245	ACCIAIO ZINCATO / GALVANIZED STEEL	GOMMA NATURALE / NATURAL RUBBER
CFNRNRX9245	ACCIAIO INOX AISI 316 / AISI 136 STAINLESS STEEL	GOMMA NATURALE / NATURAL RUBBER
CFNE9245	ACCIAIO ZINCATO / GALVANIZED STEEL	ELASTOMERO TERMOPLASTICO / THERMOPLASTIC ELASTOMER
CFNEX9245	ACCIAIO INOX AISI 316 / AISI 136 STAINLESS STEEL	ELASTOMERO TERMOPLASTICO / THERMOPLASTIC ELASTOMER

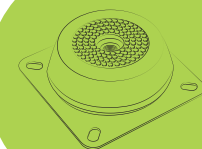

15050

CODICE / CODE	STRUTTURA METALLICA / METAL STRUCTURE	CORPO ELASTICO / ELASTIC BODY
CFNARNR15050	ACCIAIO ZINCATO / GALVANIZED STEEL	GOMMA NATURALE / NATURAL RUBBER
CFNARNRX15050	ACCIAIO INOX AISI 316 / AISI 136 STAINLESS STEEL	GOMMA NATURALE / NATURAL RUBBER
CFNAE15050	ACCIAIO ZINCATO / GALVANIZED STEEL	ELASTOMERO TERMOPLASTICO / THERMOPLASTIC ELASTOMER
CFNAEX15050	ACCIAIO INOX AISI 316 / AISI 136 STAINLESS STEEL	ELASTOMERO TERMOPLASTICO / THERMOPLASTIC ELASTOMER

**A RICHIESTA
ON REQUEST**



VERSIONE CON BUSSOLA FILLETATA ANTISTRAPPO

Consente al Cliente di acquistare i componenti e assemblarli successivamente secondo la reale necessità elastica.

Questa versione è disponibile per tutti i modelli della serie, in tutte le combinazioni previste per la versione standard.

VERSION WITH ANTI-TEAR THREADED BUSHING

The Customer can purchase the components and assemble them later based on actual elastic requirements.

This version is available for all models in the series, in all the combinations provided for the standard version.



MARTINETTO

1. grano filettato con sede per chiave a brugola,
2. dado basso UNI 5589,
3. rondella elastica spaccata UNI 1751,
4. disco in acciaio da 4.0 mm per sostenere la macchina,
5. dado alto UNI 5587 per registrare il livello della macchina,
6. disco in acciaio da 4.0 mm per distribuire il carico sull'antivibrante.

Disponibile in M10 - M12 - M16 - M20 anche in ACCIAIO INOX AISI 316.

JACK

1. threaded set screw with slot for allen key,
2. UNI 5589 low hexagon nut,
3. UNI 1751 split elastic washer,
4. 4.0-mm steel disc to support the machine,
5. UNI 5587 high hexagon nut to level the machine,
6. 4.0 mm steel disc to distribute the weight on the anti-vibration mount.

Available in M10 - M12 - M16 - M20 and in AISI 316 STAINLESS STEEL.

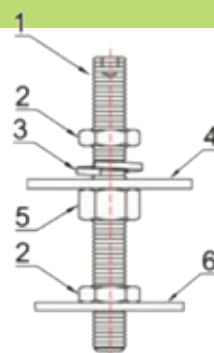
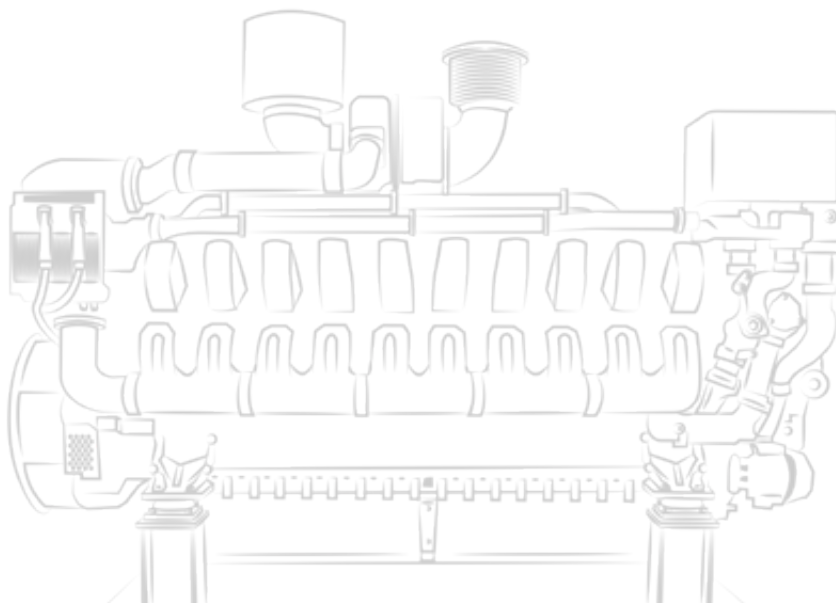

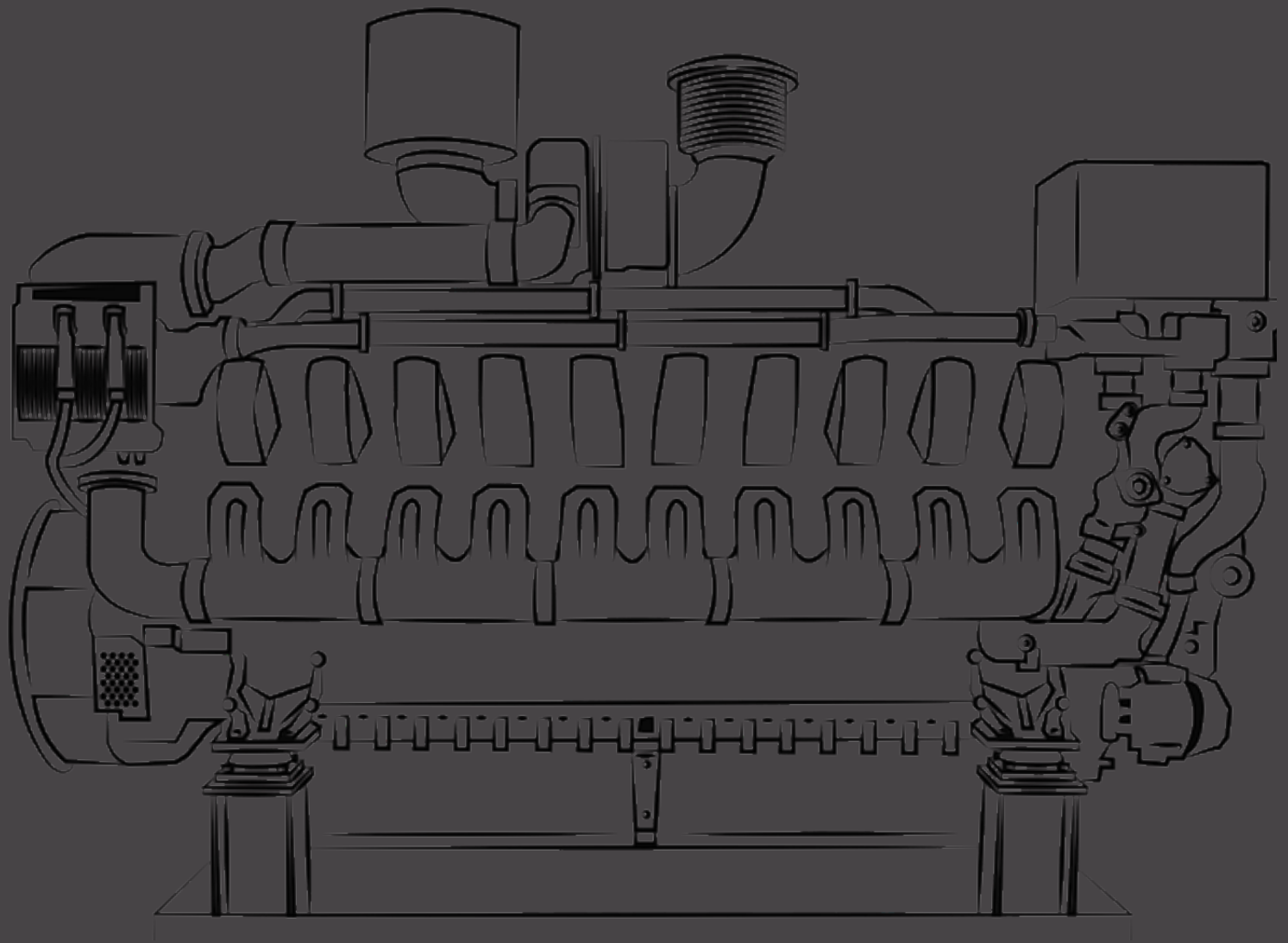

Soleco

engineering s.r.l.

www.solecosrl.com - soleco@solecosrl.com

via Masaccio 12, 20096 Pioltello (Mi) - Italy tel +39 02 92 44 311 - fax +39 02 73 96 50 50
cod.fisc. e p.IVA 01349290153 - reg. impr. MI 148283 M.9711244 - R.E.A. MI 835036