

CARTRIDGES FOR CSR FILTER CARTUCCE PER FILTRI CSR

DRIER CARTRIDGES MECHANICAL CARTRIDGES

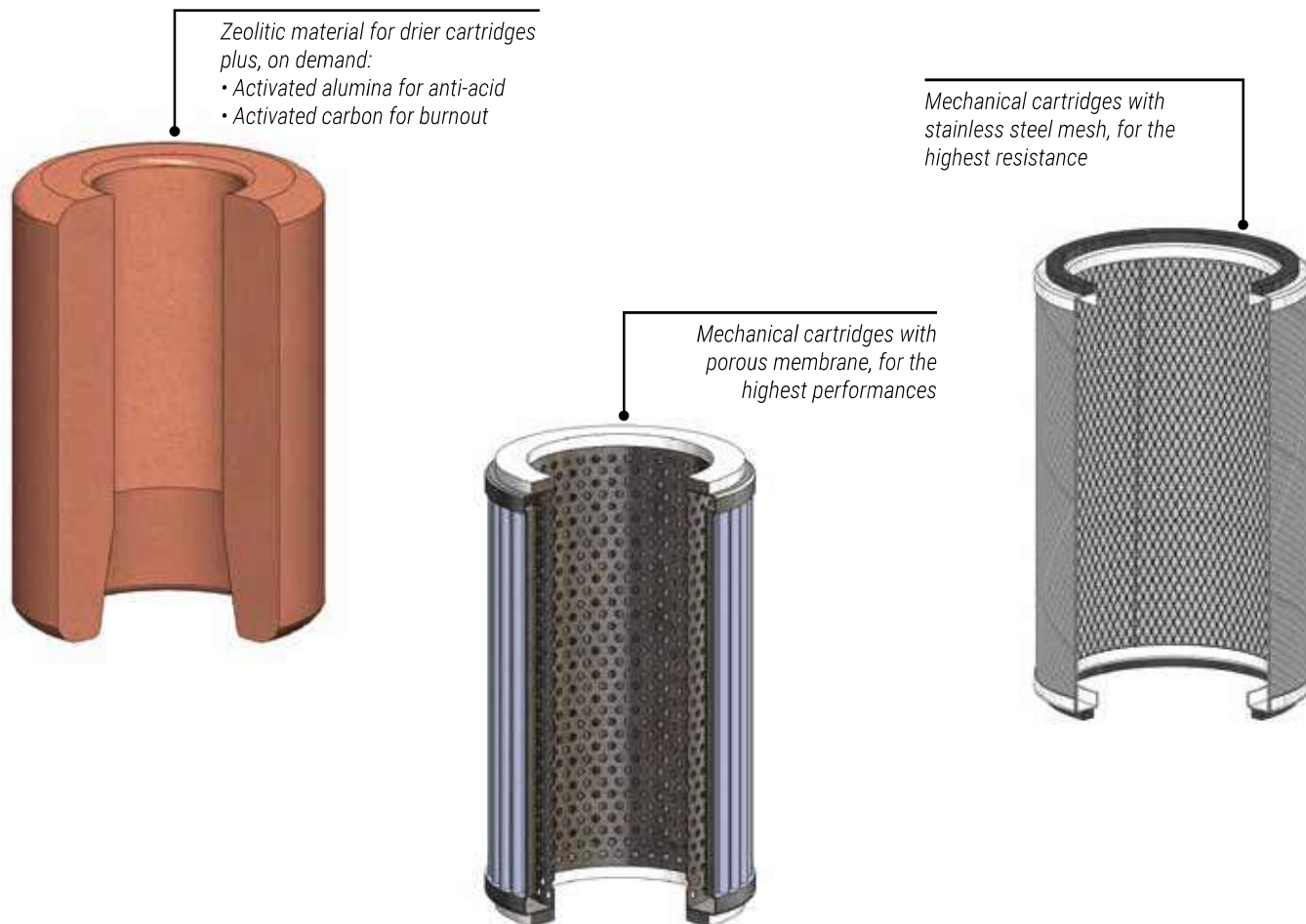

CONSTRUCTION

The cartridges for the CSR filters are of two macro-types:

- Drier cartridges:
 - **CSR48**: Compact cartridges composed of zeolite material, to obtain a highly selective 3Å molecular sieve.
 - **CSR48A**: With the addition of 20% activated alumina, for antacid use.
 - **CSR48AA**: With the further addition of 5% activated carbon, for burn-out cleaning.
- Mechanical cartridges:
 - **MFC48**: Filter cartridges consisting of a metal mesh and a perforated sheet with a filter membrane of porous material interposed, capable of retaining solid particles larger than 20 µm in size.
 - **MFC48S**: Filter cartridges composed of a mesh in stainless steel joined metal fabric and an expanded metal mesh capable of retaining solid particles larger than 120 µm.

APPLICATION

Cartridges, of any type, are excluded from the scope of the PED Directive 2014/68/EU.

COSTRUZIONE

Le cartucce di ricambio per i filtri CSR sono di due macro-tipologie:

- Cartucce disidratanti:
 - **CSR48**: Cartucce compatte composte da materiale zeolitico, per ottenere un setaccio molecolare con pori da 3Å altamente selettivo.
 - **CSR48A**: Con l'aggiunta di un 20% di allumina attivata, per un utilizzo antiacido.
 - **CSR48AA**: Con l'ulteriore aggiunta di un 5% di carbonio attivato, per una pulizia burn-out.
- Cartucce meccaniche:
 - **MFC48**: Cartucce filtranti costituite da una rete metallica e una lamiera forata con interposto un setto filtrante di materiale poroso, in grado di trattenere particelle solide di dimensioni più grandi di a 20 µm.
 - **MFC48S**: Cartucce filtranti composte da una rete in tessuto metallico unito di acciaio inossidabile e una lamiera stirata a maglie in grado di trattenere particelle solide più grandi di a 120 µm.

AMBITO DI APPLICAZIONE

Le cartucce, di qualunque tipologia, sono escluse dallo scopo della Direttiva PED 2014/68/EU.

CARTRIDGES

Type	Technical characteristics	Application	Surface [cm ³]	Filtering capacity [µm]	Nominal Volume		Dimensions [mm]			Weight [kg]	Pcs per box
					[in3]	[cm ³]	ØD	ØD1	H		
CSR48	100% molecular sieve	Drier	435	-	48	800	47	96	140	750	12
CSR48A	80% molecular sieve + 20% act. alumina	Drier - Antiacid	435	-	48	800	47	96	140	750	12
CSR48AA	75% molecular sieve + 20% act. alumina + 5% act. carbon	Drier - Burn-out	435	-	48	800	47	96	140	750	12
MFC48	Mechanical cartridge	Filtering	820	> 20	-	-	60	87	148	265	5
MFC48S	Stainless steel mechanical cartridge	Filtering	390	> 120	-	-	69	90	148	112	5

● CSR48 | CSR48A | CSR48AA Series

● MFC48 Series

● MFC48S Series

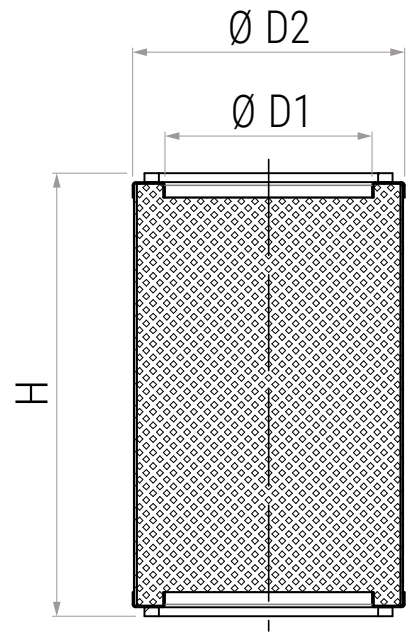
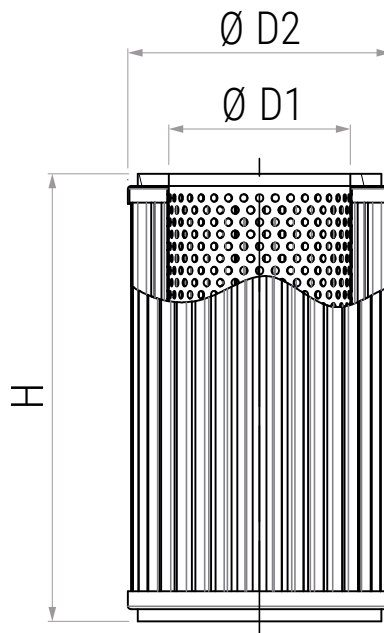
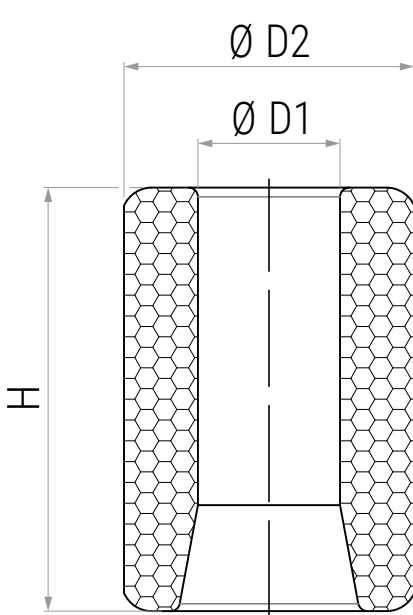

CARTRIDGES Water Capacity⁽¹⁾ & Dehydratable Charge

Type	+24 °C								+52 °C							
	Water Capacity				Dehydratable Charge				Water Capacity				Dehydratable Charge			
	[gH ₂ O]				[kgREFRIGERANT]				[gH ₂ O]				[kgREFRIGERANT]			
	R134a	R404A R507	R407C	R410A	R134a	R404A R507	R407C	R410A	R134a	R404A R507	R407C	R410A	R134a	R404A R507	R407C	R410A
CSR48	87	89	85	87	96	99	92	97	74	76	71	74	82	84	78	82
CSR48A	74	76	71	73	82	84	79	81	69	73	55	57	70	76	59	63

NOTES:

⁽¹⁾ The dehydrating capability is based on the humidity content in the refrigerant, before and after drying, at the conditions set by the ARI STANDARD 710, that assumes: Liquid temperature: +24 °C and +52 °C. Equilibrium Point Dryness (EPD) for R134a, R404A, R407A, R410A, R507: 50 ppm of H₂O.