

DRAWING MADE BY
CAD
HAND MADE MODIFICATIONS ARE FORBIDDEN

CCW ROTATION
ROTAZIONE ANTIORARIA

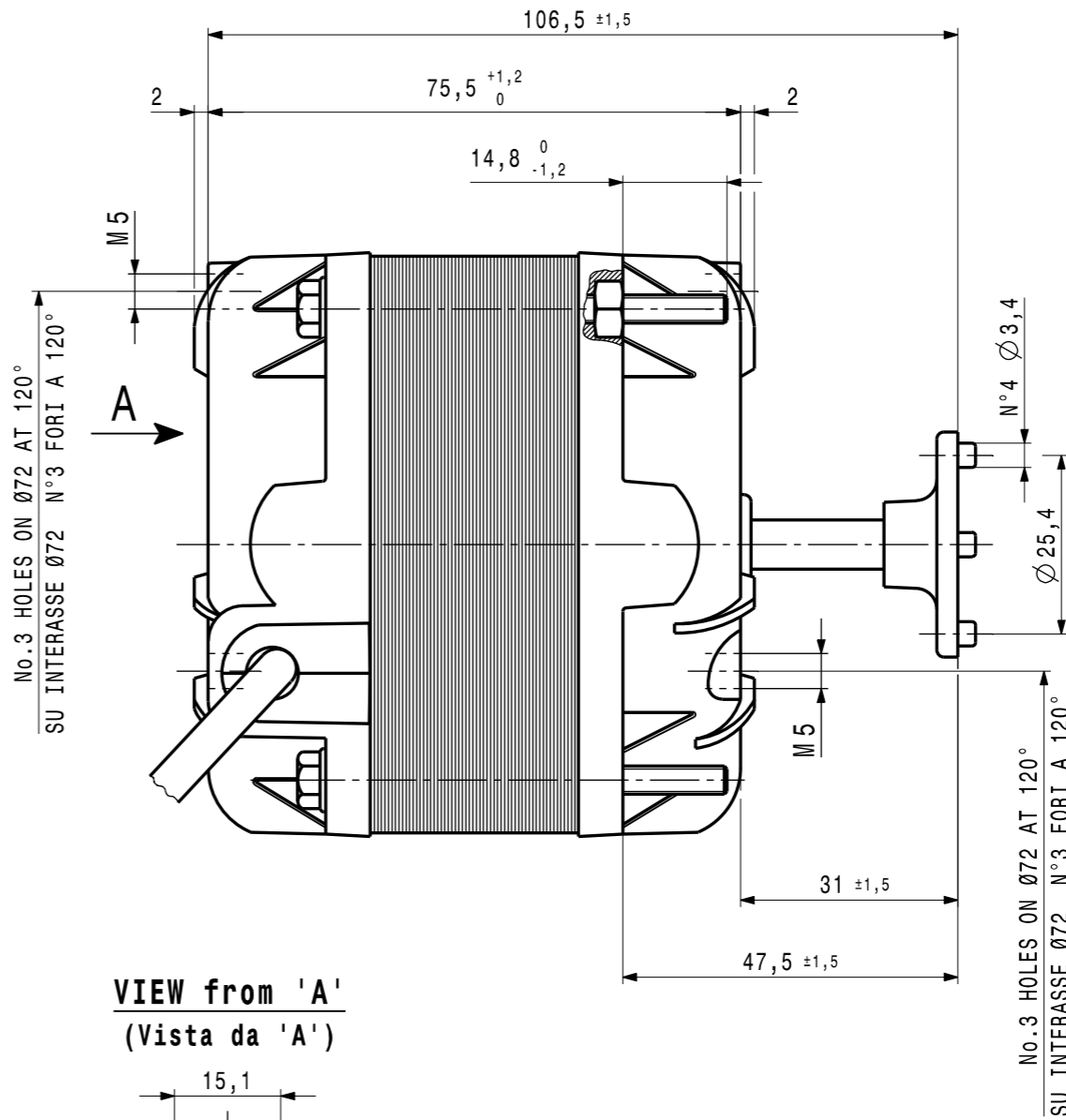

VIEW from 'A'
(Vista da 'A')

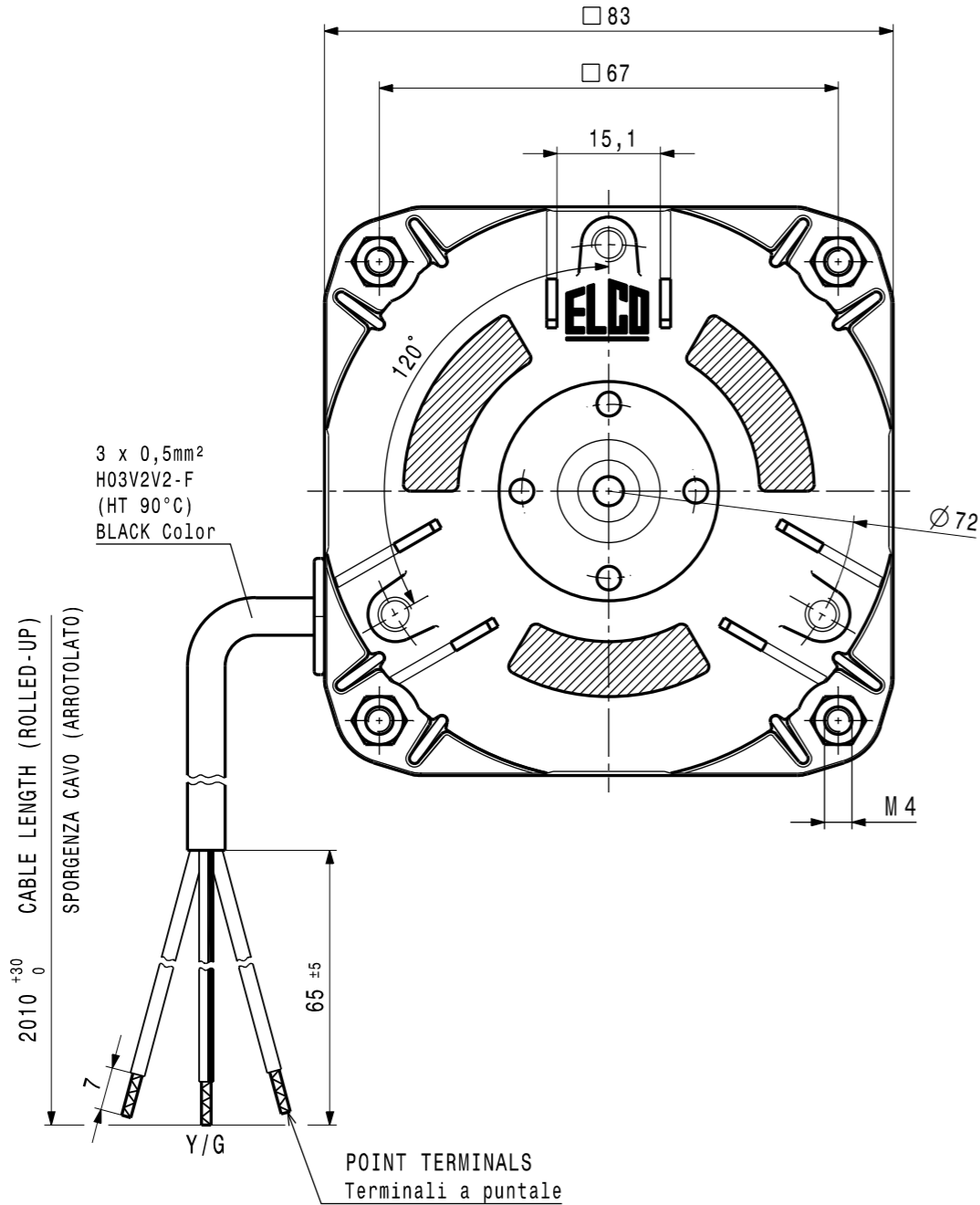
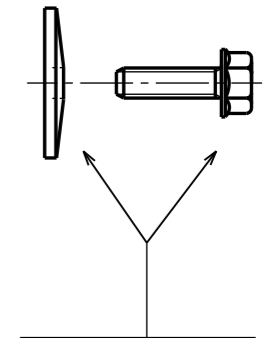
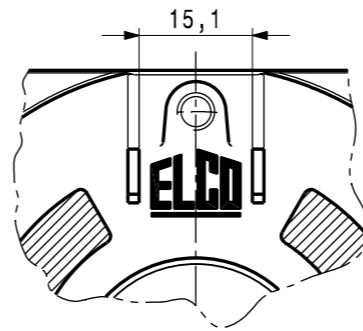

PARTS SUPPLIED LOOSE
PARTICOLARI
FORNITI A PARTE

- ASSEMBLY NOTE :RULE EL.UN.0002
- MECHANICAL CHECK :RULE EL.CM. 001
- LABEL LOCATION :RULE EL.UN.0053
- ELECTRICAL CHECK: M.596

- ALUMINIUM END-SHIELDS (Coperchi in alluminio)
- OPEN FRONT COVER (Coperchio anteriore sfinestrato)
- OPEN BACK COVER (Coperchio posteriore sfinestrato)

N 25-30 /718 DATE
230V~ 50Hz
25/110W 0,75A 1300Rpm
PROT.TERM. CL.B
CE
NET8T25PNN203



For dim. without tolerance see standard UNI EN 22768-mK		Treatment -	A3	Release A
Material -		MOTOR N 25-30 /718		
Date 25-02-02		230V ~ 50Hz		Weight - Ref.No Ex.4-064-197
Check -		NET8T25PNN203		
Scale 1:1				

MODIFICATIONS

1	2	3	4	THIS DRAWING IS OUR PROPERTY. ANY PARTIAL OR COMPLETE COPY IS FORBIDDEN WITHOUT PREVIOUS WRITTEN AUTHORISATION	
---	---	---	---	--	--