

## Tappi per profilati UNI

Material : PP - black

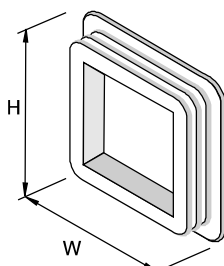

Numero Articolo	W mm	H mm	KG /100	
1401001	27	18	0.4	100
PVCUNI1	30	15	0.3	100
PVCUNI2	30	30	0.6	100
PVCUNI3	35	20	0.4	100

## Dado a martello per profili UNI 1 & 2

Material : Bullone: DD11 - EN 10111  
Rondella in acciaio DX51 - EN 10327  
Vite: 8.8 - DIN933; Parte in Plastica PP  
Finitura : Zincatura elettrolitica - EN ISO 12329



QLFN

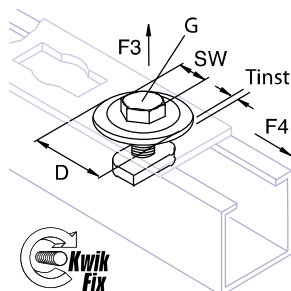

Numero Articolo	D mm	G	T mm	F3 kN	F4 kN	Tinst Nm	SW	KG /100	
1370810	30	M8	2.5	1.5	0.6	10	13	3.5	100

## Piastra autobloccante per profilati UNI 1 & 2

Material : Bullone: DD11 - EN 10111  
Rondella in acciaio DX51 - EN 10327; Parte in Plastica PP  
Finitura : Zincatura elettrolitica - EN ISO 12329

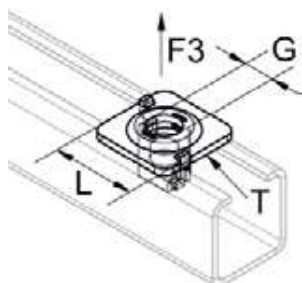
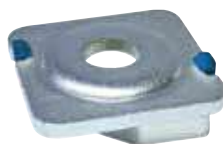

Numero Articolo	G	L mm	W mm	T mm	F3 kN	KG /100	
1370640	M6	30	30	2.5	1.5	2.7	100
1370840	M8	30	30	2.5	1.5	2.6	100
1371040	M10	30	30	2.5	1.5	2.4	100

Staffaggio serie leggera

TYCITSUP